

Dimension: (UNIT:mm)

A	12.5 ± 0.3
B	9.0-0.4
C	6.5 <sup>-0.15</sup>
D	4.5+0.2
E	10 ± 0.3
F	4.5 <sup>0</sup> <sub>-0.3</sub>
G	2.5-0.2
H	

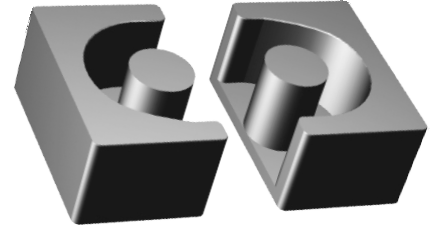
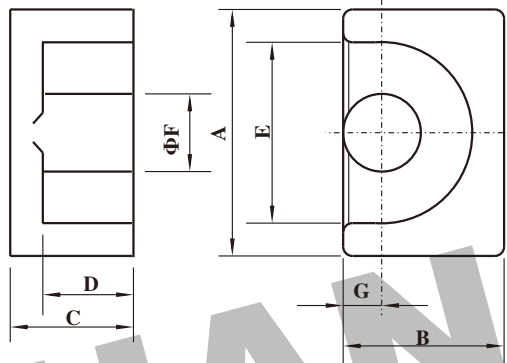

**Test conditions**

AL: F=10.0KHz U=0.3V N=10Ts

**Effective parameter**

C1(mm) <sup>-1</sup>	Ae(mm <sup>2</sup> )	Le(mm)	Ve(mm <sup>3</sup> )	Weight(g)
1.24	19.5	24.2	472	≈4.7

Core sets of high permeability grades.

Clamping force for Al measurements,30+/-10N

Grade	AL (nH)	μe	Type number
H7K	4900±25%	≈4540	EP 13-H7K
H10K	7000+40/-30%	≈6900	EP 13-H10K
H12K	8500+40/-30%	≈8400	EP 13-H12K

Core sets for filter applications.

Clamping force for Al measurements,30+/-10N.

**Properties of core sets under power conditions**

Grade	AL (nH)	μe	AIR GAP μm	Type number
P4	40 ± 3%	≈ 40	≈ 1000	EP 13-P4
	63 ± 3%	≈ 62	≈ 540	EP 13-P4
	100 ± 3%	≈ 99	≈ 300	EP 13-P4
	160 ± 3%	≈ 158	≈ 170	EP 13-P4
	250 ± 5%	≈ 247	≈ 100	EP 13-P4
	1650 ± 25%	≈ 1630	≈ 0	EP 13-P4
HQ2KA	1500 ± 25%	≈ 1480	≈ 0	EP 13-HQ2KA
HQ2K	40 ± 3%	≈ 40	≈ 1000	EP 13-HQ2K
	63 ± 3%	≈ 62	≈ 540	EP 13-HQ2K
	100 ± 3%	≈ 99	≈ 300	EP 13-HQ2K
	160 ± 3%	≈ 158	≈ 170	EP 13-HQ2K
	250 ± 5%	≈ 247	≈ 100	EP 13-HQ2K
	1325 ± 25%	≈ 1310	≈ 0	EP 13-HQ2K
P5	1100 ± 25%	≈ 1090	≈ 0	EP 13-P5

Grade	B (mT)at H=250 A/m F=25KHz T=100 °C	Core loss (w) at			
		F=25 KHz B=200mT T=100 °C	f=100 KHz B=100mT T=100 °C	F=100 KHz B=200mT T=100 °C	F=400 KHz B=50mT T=100 °C
P4	≥ 320	-	≤ 0.04	≤ 0.22	-
HQ2KA	≥ 340	-	≤ 0.03	≤ 0.17	≤ 0.075
HQ2K	≥ 315	-	≤ 0.05	-	≤ 0.1
P5	≥ 300	-	-	-	≤ 0.04

**Properties of core sets under power conditions (continued)**

Grade	B (mT)at H=250 A/m F=25KHz T=100 °C	Core loss (w) at			
		F=500 KHz B=50mT T=100 °C	F=500 KHz B=100mT T=100 °C	F=1.0 MHz B=30mT T=100 °C	F=3.0MHz B=10mT T=100 °C
P4	≥ 320	-	-	-	-
HQ2KA	≥ 340	≤ 0.15	-	-	-
HQ2K	≥ 315	-	-	-	-
P5	≥ 300	≤ 0.06	≤ 0.45	-	-

**Note:**

- 1:Document is the property of FUAN Inc & is not allow to be duplicated without authorization
- 2:RoHS compliant.